



INSTALLATION INSTRUCTIONS

APPLICATION: 2003-UP GMC SIERRA 2500/3500HD 2/4 WHEEL DRIVE

AUTOMOTIVE PRODUCTS, INC.

GRILLE GUARD

35-5170

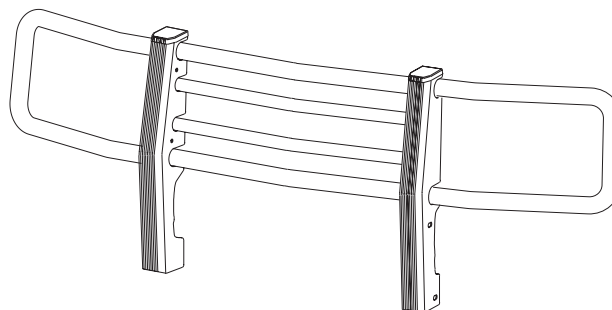

PARTS KIT CONTENTS

ITEM	QTY	DESCRIPTION	ITEM	QTY	DESCRIPTION
1	2	UPRIGHT ASSEMBLY	11	4	1/2" FLAT WASHER
2	1	CENTER SECTION ASSEMBLY	12	8	1/2" FLAT WASHER, BLUE ZINC
3	2	TOP BRACKET, PASSENGER AND DRIVER	13	4	1/2" LOCK WASHER
4	2	BOTTOM BRACKET, PASSENGER AND DRIVER	14	6	1/2" LOCK WASHER, BLUE ZINC
5	2	SPACER PLATE	15	4	1/2-13 HEX NUT, BLUE ZINC
6	2	SPACER TUBE	16	6	3/8-16 X 1.25" BUTTON HEAD BOLT
7	4	RUBBER U-CHANNEL	17	12	3/8" FLAT WASHER
8	4	1/2-13 X 1.25" BUTTON HEAD BOLT	18	6	3/8-16 LOCK NUT
9	2	1/2-13 X 1.25" HEX HEAD BOLT, BLUE ZINC			
10	2	M12-1.75 X 120MM HEX HEAD BOLT			

TOOLS REQUIRED

3/4" SOCKET	3/4" WRENCH	9/16" SOCKET	9/16" WRENCH	10MM SOCKET
15MM SOCKET	18MM SOCKET	19MM SOCKET	PHILLIPS SCREWDRIVER	
RATCHET	SOCKET EXTENSION	TORQUE WRENCH	SMALL FLAT SCREWDRIVER	

- STEP 1. Remove the contents from box and check for damage. Verify all parts are present. Read instructions completely before beginning.
- STEP 2. Determine passenger and driver uprights and center section assembly and assemble as shown. **SEE FIGURE 4.** Hand tighten all fasteners centered in slots or holes. Be sure dimple in ring mount plate is to the top.
- STEP 3. For easier installation, it may be necessary to remove grille from vehicle but it's not necessary on all models. Remove plastic shroud to gain access to grille by removing seven plastic pin retainers. Pull center pin up with a small flat tip screwdriver. Remove 6mm bolt from top of grille. Pull on outer edge of grille by applying firm pressure away from the fender, repeat on the opposite side and center section. Carefully remove grille from vehicle. **SEE FIGURE 2 .**
- STEP 4. Determine passenger and driver top and bottom brackets. Remove factory bumper bolts from top side of frame (located behind the top side of bumper), then attach brackets as shown. **SEE FIGURE 1.**
- STEP 5. Attach bottom brackets as shown. Leave loose. **NOTE:** If tow hooks are present, remove for installation.
- STEP 6. If grille was removed see step 7. If not, attach grille guard as shown. Center and level grille guard as desired.

WO:

75-0492 REVISION A 8/20/07

It may be necessary to adjust center section to uprights. Torque 1/2" fasteners to 65 FT.LBS; 12mm fasteners to 60 FT.LBS. and 3/8" fasteners to 30 FT.LBS.

STEP 7. If grille was removed, attach grille guard to mount brackets as shown. Center and level grille guard as desired. Hand tighten bolts securing brackets to vehicle. Torque center section to upright fasteners to 30 FT.LBS. Remove grille guard only and re-install grille and plastic shroud. Re-attach grille guard and torque 1/2" fasteners to 65 FT.LBS; 12mm fasteners to 60 FT.LBS. and 3/8" fasteners to 30 FT.LBS.

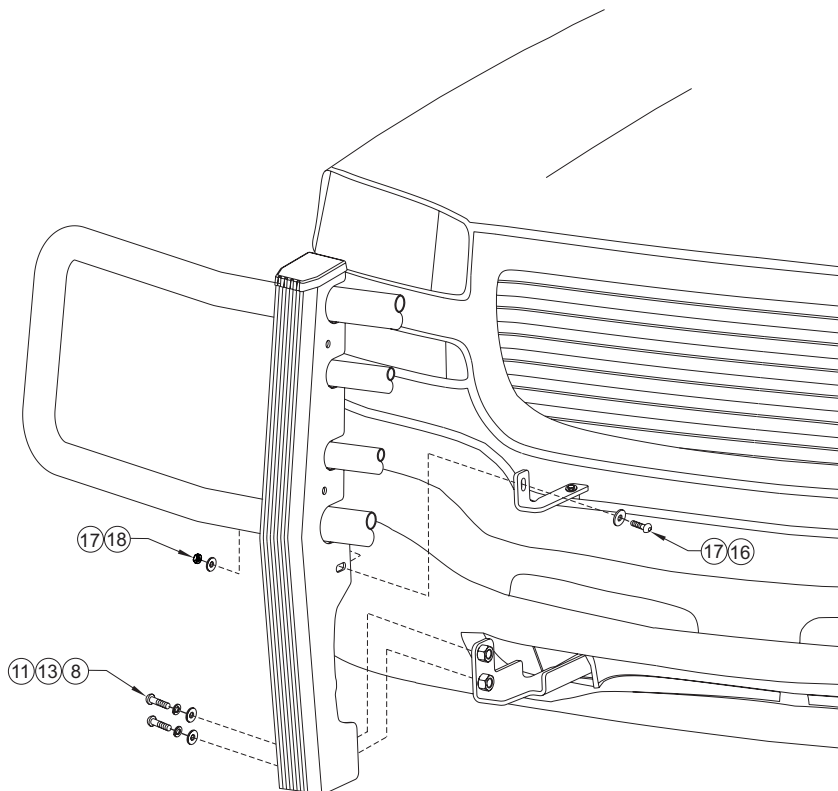
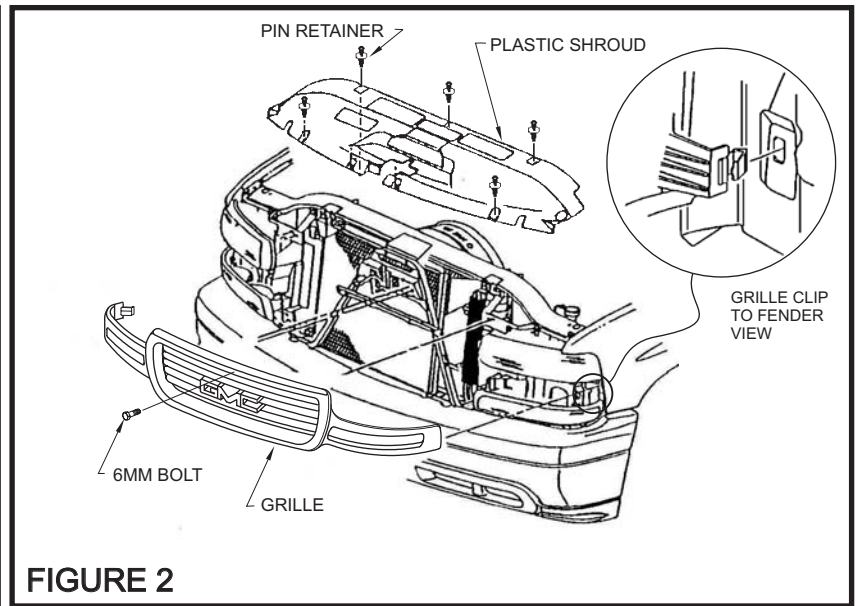
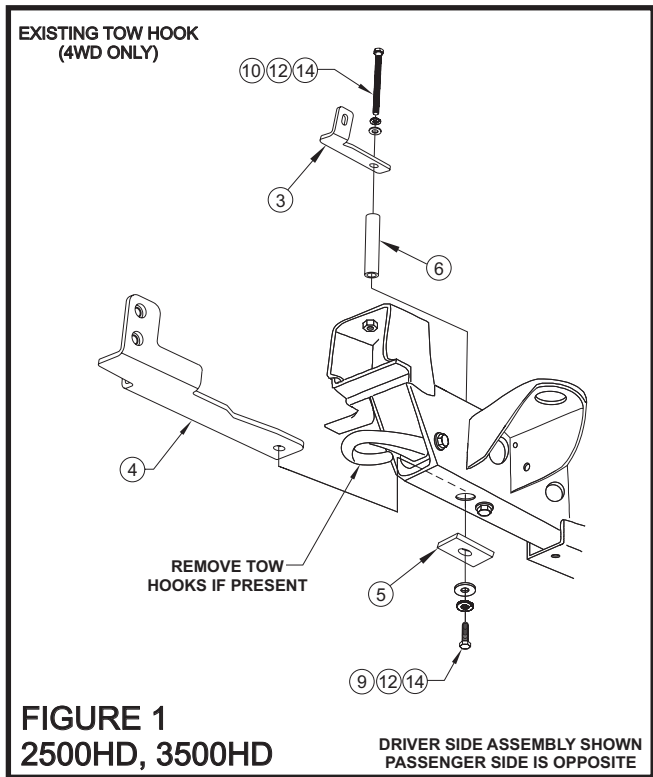

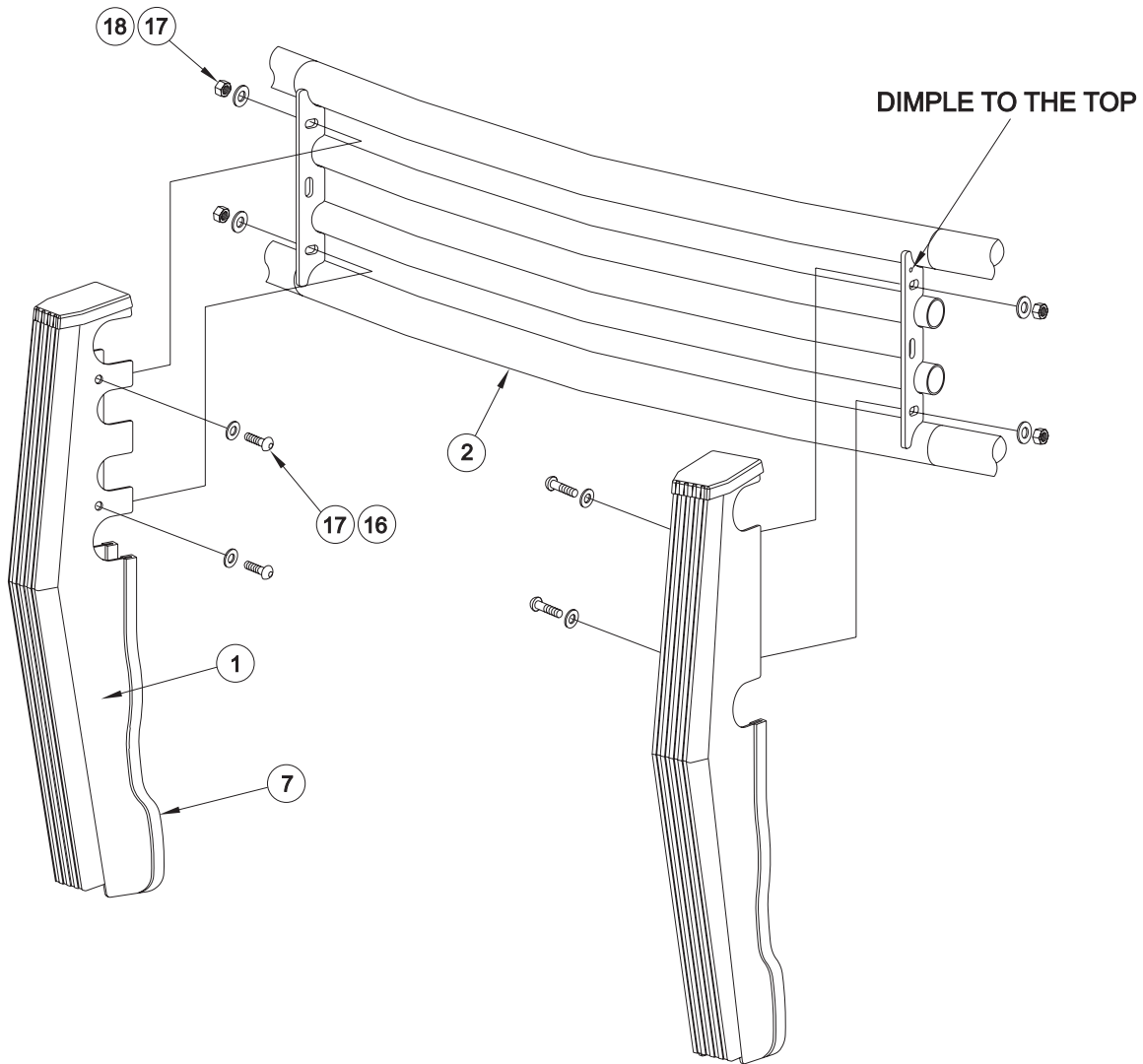

FIGURE 4

Finish protection - Westin products have a high quality finish that must be cared for like any other exposed finish on the vehicle. Protect the finish with a non-abrasive automotive wax (pure carnauba, for example) on a regular basis. The use of cleaner wax or any compound which contains an abrasive is detrimental, as the compounds scratch the finish and open it to corrosion.